

WARD CONNECTOR

J Corner and H Corner
FOR USE WITH J AND H DUCT FLANGE

CNR

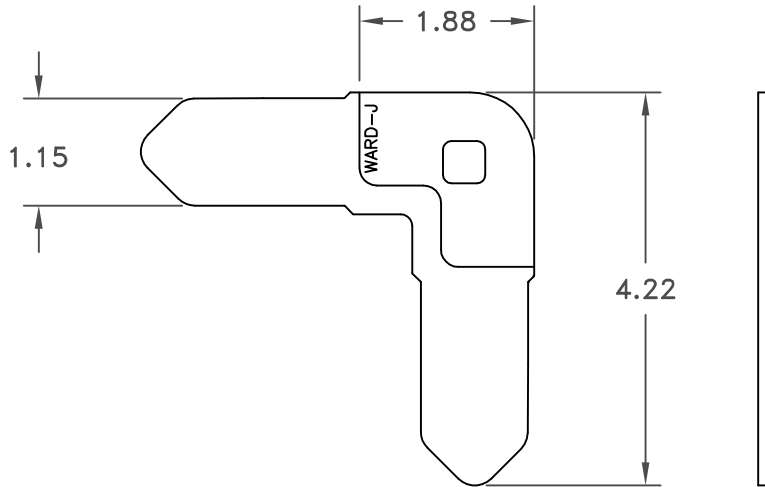

J Corner

SPECIFICATIONS:

1. J corner formed from 12 gauge metal
2. H corner formed from 12 gauge metal

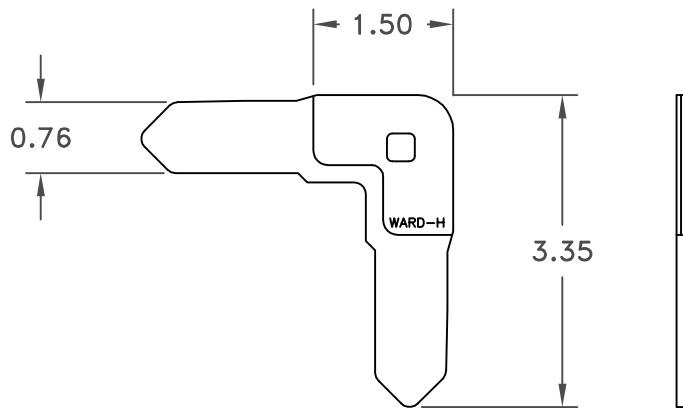

H Corner

NOTES:

1. Use J corners with Ward J flange.
2. Use H corners with Ward H flange.
3. J corners are available in the following:
 - Galvanized
 - Galvaneal
 - Aluminum
 - Aluminized
 - Stainless Steel
4. H corners are available in the following:
 - Galvanized
 - Galvaneal
 - Aluminized
5. Nuts and bolts included (galvanized)

JOB NAME: _____	SUBMITTED BY: _____
LOCATION: _____	
ARCHITECT: _____	
ENGINEER: _____	
CONTRACTOR: _____	



5030 Corporate Exchange Blvd SE • Grand Rapids MI 49512
T (800) 624-8642 • F (800) 972-1421 • www.wardind.com